

Technical Bulletin N°04

REFERENCE	BT_2017_FR20_04_UK
DATE	2017-04-06
SUBJECT	Gearbox Oil Level + Rear wing bolt + rear view mirror + Race Number on the monocoque + video camera bracket painting/covering + new design for clutch housing
PARTS	Gearbox Oil – Rear wing- Rear view mirror-video camera bracket-clutch housing

1. Gearbox oil level

Renault Sport Racing will introduce from 1st race event in Monza scrutineering on gearbox oil level. Please find below the oil level checking process:

- Checking will be carried out after a run of the car. (Meaning car liquids are in their warm operating range).
- Car will be install on its 0° position. (Using top machined surfaces of engine cylinder head oil strainer). Please refer to 2017 User manuel B – Chassis ; page 127 & 128.
- Then, after removing the underfloor, team will drain the gearbox by loosening **only the front plug** as shown below on the picture :

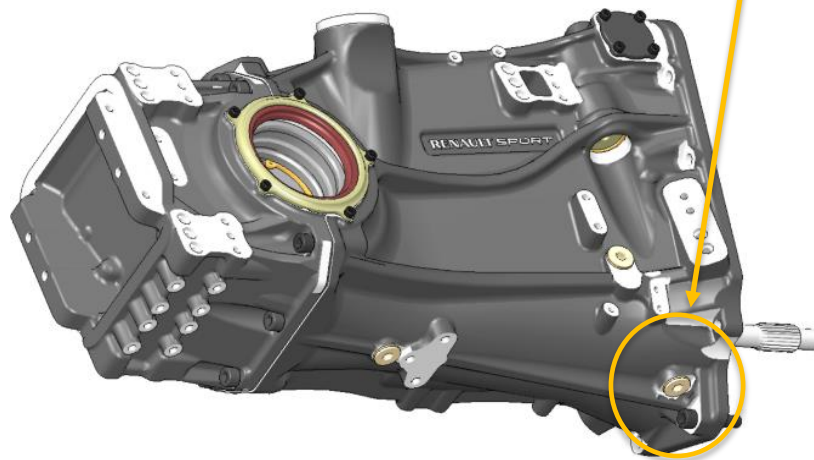

- A minimum of **1.25L** has to be collected in a graduated cylinder provided by Renault Sport Racing organization.

2. Rear upper mainplane bolt dimension

Renault Sport Racing would like to inform you about disparities in rear upper mainplane bolt dimension: 2 sizes of bolt are allowed to maintain the rear upper mainplane inside the groove (only on that point): M6 and M5 bolts.

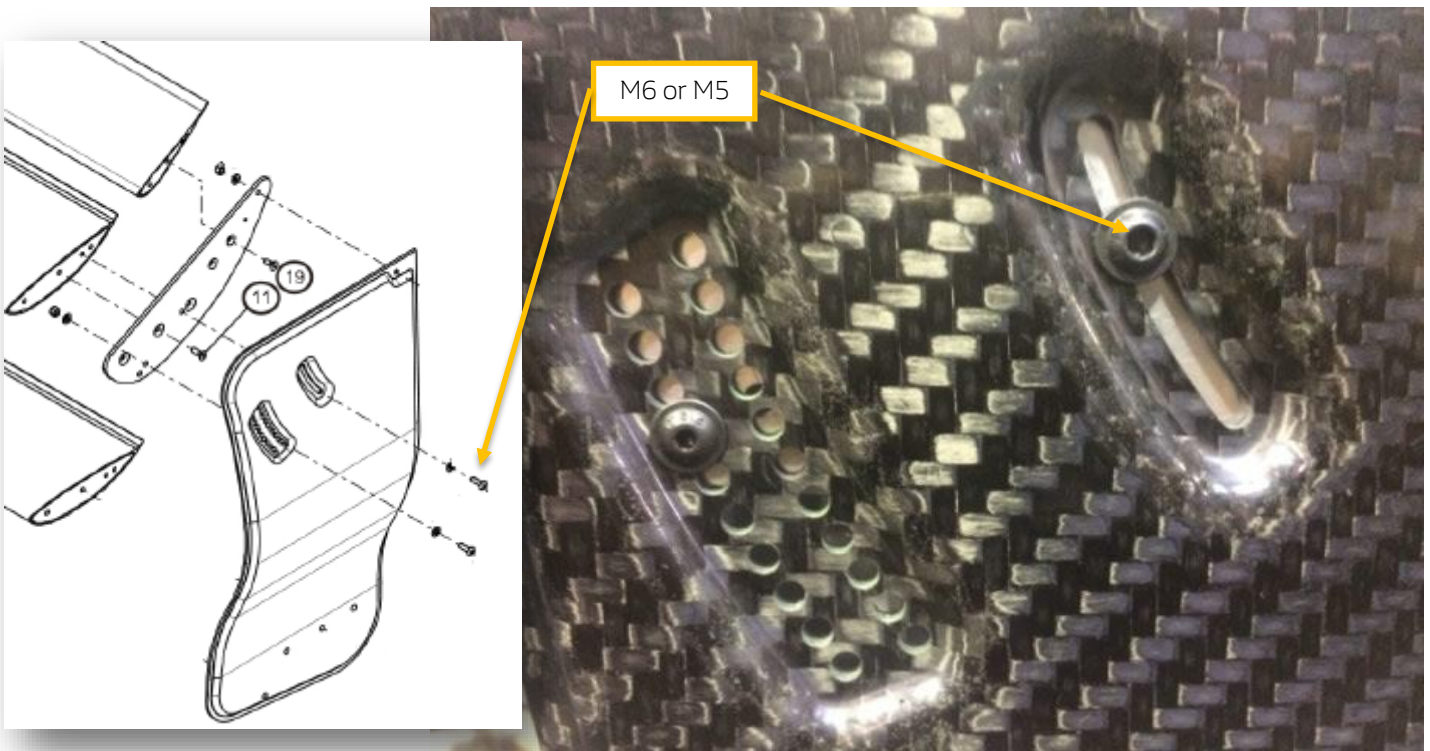

3. Rear view mirror

From first race meeting at Monza, only reference 77 11 165 880 – 77 11 165 882 (Left std & convex) and 77 11 165 881 – 77 11 165 883 (Right std & convex) are allowed. Old specification with curve-shaped are not anymore allowed.

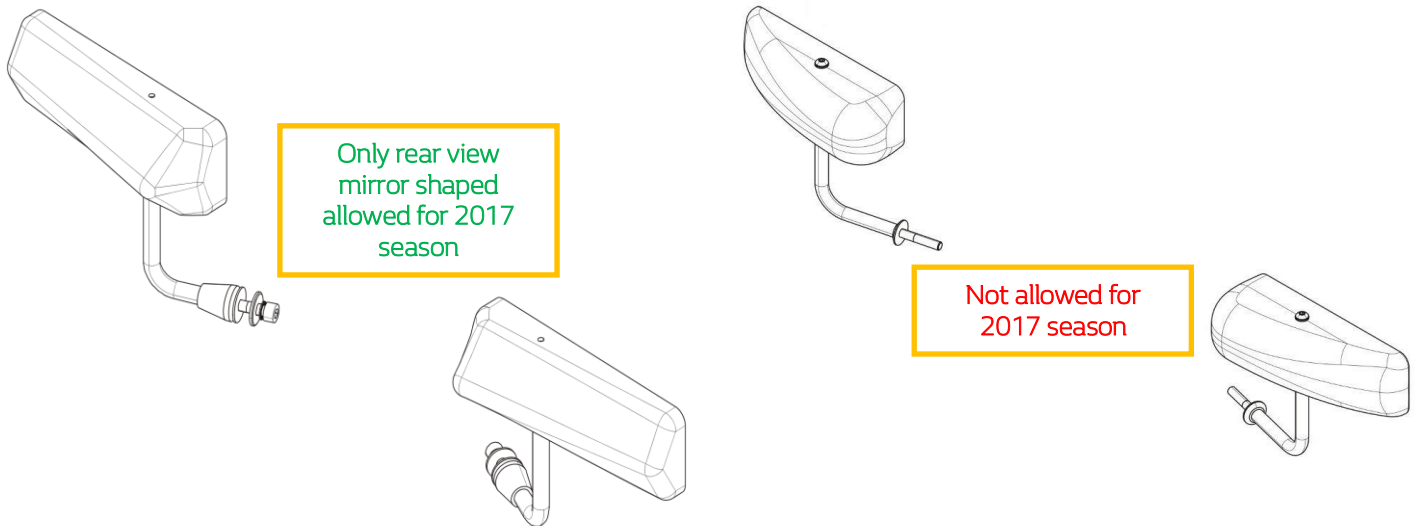

4. Race number on the monocoque

As request on the Marking_sheet_FR 2_0 EUROcup_2017, Renault Sport Racing would like to remind you that you have to place the driver number on the monocoque as shown below – reference N°12.

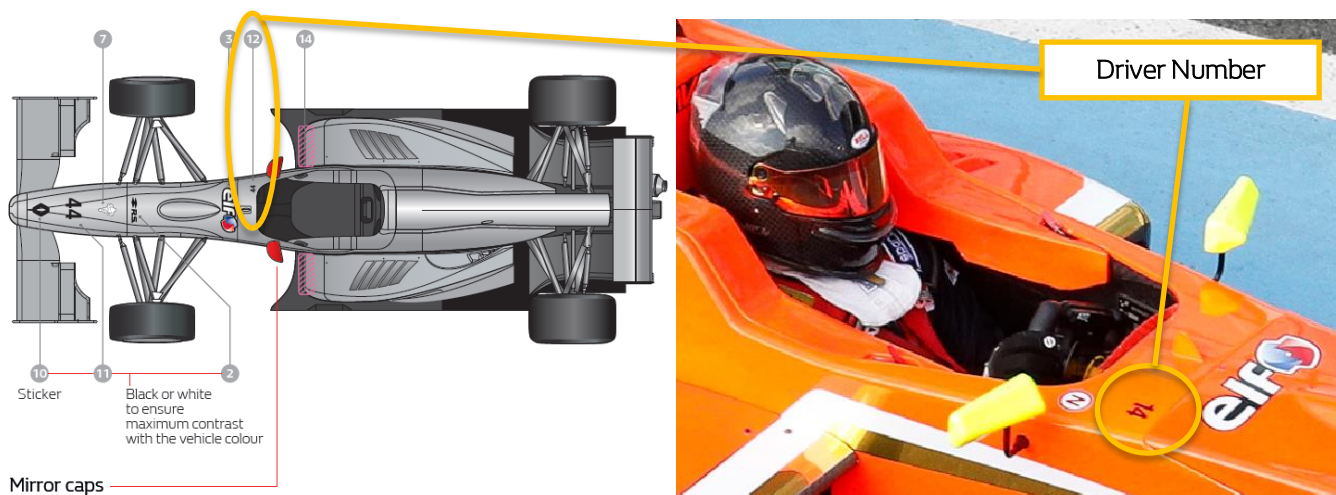

5. Video camera bracket painting/covering

Renault Sport Racing inform you that you are allowed to paint/cover the video camera bracket with the color of your choice. Please note that it's forbidden to cover/paint the GPS antenna.

6. Clutch housing new design

Renault Sport Racing will introduce during 2017 season a new clutch housing design. Please see below the modification done, shape for fitting point move from U-shaped to V-shaped. Reference remains the same.



Old specification : U-shaped



New specification : V-shaped

Renault Sport Racing
Vehicle Design Department